



62 Our catering sinks designs

63 Straight edges Comfort catering sinks

- 64 Catering sinks with sink cover
- 65 Catering sinks without sink cover
- 66 Special dishwasher
- 66 Pastry sink
- 67 Sink units

69 Rounded edge catering sinks

- 70 Standard catering sinks
- 71 Customized catering sinks
- 72 Standard suspended and semi-suspended catering sinks
- 73 Sink units
- 74 Special dishwasher
- 75 Standard pot washing sinks
- 76 Customized pot washing sinks

77 Sinks with square welded bases

- 78 Basic sinks with sink cover
- 79 Basic sinks with sink cover and bottom shelf

80 Options

82 Accessories



CATERING SINKS

Straight edges – Comfort



Rounded edge



Square welded bases – Tradition



SCAN ME and download
all the technical datasheets of the range!

CATERING SINKS

Rounded edge catering sinks

The rounded edge range meet the requirements of the architects and kitchen consultants for the tenders.



SCAN ME and download all the technical datasheets of the range!



FOCUS ON...



Welded corners



Sloped backplash

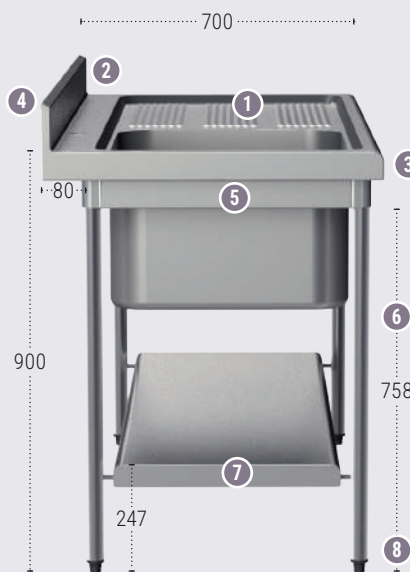

- 1 Work top in AISI 304L stainless steel 1.5 mm thickness
- 2 10 mm curve
- 3 Welded corners, 20 mm radius, front rounded edge, 60 mm thick work top
- 4 Backsplash with 30° slope edge 100 x 20 mm (optional: rear closed)
- 5 100% stainless steel body
- 6 Tubular stainless steel feet, Ø 38 mm, collapsible
- 7 Rounded edge removable bottom shelf, EGA type, optional
- 8 ABS feet adjustable up to 30 mm



turn'fix

Quick and safe tool
free assembly

- ☐ Easier
- ☐ Quicker
- ☐ More robust



SCAN ME for the turn'fix video!

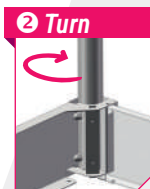
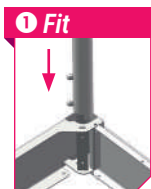

Bottom shelf slots into the legs in a single movement. No more useless handling of the table

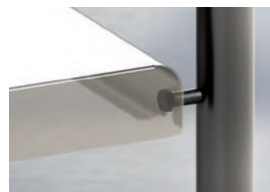



CATERING SINKS | ROUNDED EDGE CATERING SINKS

Standard rounded edge catering sinks width 700 mm



ASSEMBLED SINK COVER,
DISMANTLED FEET

- On ABS adjustable feet
- Optional rounded edge 1.5 mm thickness bottom shelf
- Racks bottom shelf see page 80

With bowl(s) L 500 x W 500 x H 300 mm - Especially for the kitchen

Standard	HEIGHT 900 mm	CATERING SINK WITHOUT SINK COVER supplied unassembled	CATERING SINK WITH SINK COVER supplied assembled	OPTIONAL SHELF supplied with sink			
				WIDTH 700			
Designation	L x W mm	Kg	Ref.	Kg	Ref.	Kg	Ref.
1 bowl	700 x 700	26	PA107	28	PAP107	5	EGA707
1 bowl + right drainer	1200 x 700	32	PA112D	35	PAP112D	8	EGA712
1 bowl + left drainer	1200 x 700	32	PA112G	35	PAP112G	8	EGA712
2 bowls	1200 x 700	36	PA212	39	PAP212	8	EGA712
2 bowls + right drainer	1600 x 700	40	PA216D	45	PAP216D	11.5	EGA716
2 bowls + left drainer	1600 x 700	40	PA216G	45	PAP216G	11.5	EGA716
2 bowls + right drainer	1800 x 700	44	PA218D	50	PAP218D	12.5	EGA718
2 bowls + left drainer	1800 x 700	44	PA218G	50	PAP218G	12.5	EGA718
2 bowls + 2 drainers	2100 x 700	64	PA221	71	PAP221	14	EGA721

Shipping within 48h

With bowl(s) L 600 x W 500 x H 300 mm

Standard	HEIGHT 900 mm	CATERING SINK WITHOUT SINK COVER supplied unassembled	CATERING SINK WITH SINK COVER supplied assembled	OPTIONAL SHELF supplied with sink			
				WIDTH 700			
Designation	L x W mm	Kg	Ref.	Kg	Ref.	Kg	Ref.
1 bowl	800 x 700	27	PA108	29	PAP108	5.5	EGA708
1 bowl + right drainer	1400 x 700	34	PA114D	37	PAP114D	9.5	EGA714
1 bowl + left drainer	1400 x 700	34	PA114G	37	PAP114G	9.5	EGA714
2 bowls	1400 x 700	38	PA214	41	PAP214	9.5	EGA714
1 bowl + right drainer	1500 x 700	40	PA115D	45	PAP115D	10.5	EGA715
1 bowl + left drainer	1500 x 700	40	PA115G	45	PAP115G	10.5	EGA715
2 bowls	1500 x 700	42	PA215	47	PAP215	10.5	EGA715
2 bowls + right drainer	1900 x 700	46	PA219D	52	PAP219D	13	EGA719
2 bowls + left drainer	1900 x 700	46	PA219G	52	PAP219G	13	EGA719
2 bowls + 2 drainers + shelf, 6 feet	2400 x 700	68	PA224	74	PAP224	-	-

Shipping within 48h

OPTIONS
pages 80-81



ACCESSORIES
page 82





Customized rounded edge catering sinks without sink cover



- Top in AISI 304L stainless steel 1.5 mm thickness, with non-drip edges
- Ribbed drainer. Smooth drainer optional (page 80)
- With sink cover optional (page 80)
- Backsplash with 30° slope edge, 100 x 20 mm (rear closure optional page 80)
- 20 mm radius front rounded edge, 60 mm thick work top
- Tubular ABS feet Ø 38 mm
- 6 feet from length : 2200 mm
- Supplied with plug, simple overflow pipe and PVC U bend
- Specify when ordering side drainer and sink(s) position



Our catering sinks are delivered with tap hole Ø 31 mm.
Without tap hole or with 2 tap holes : see options SPST and SPBT page 80.

With bowl(s) L 500 x W 500 x H 300 mm

Customized		HEIGHT 900 mm	SINK	OPTIONAL SHELF supplied with sink	
WIDTH 700					
Designation	Nb of sink	Nb of drainer	Dimension top of catering sink mm	Ref.	Ref.
	1	0	750 to 799	PA155-08	EGA7-08
	1	0	800 to 1000	PA155-10	EGA7-10
	1	1	1000 to 1199	PA155-12	EGA7-12
	1	1	1250 to 1400	PA155-14	EGA7-14
	2	0	1250 to 1399	PA255-14	EGA7-14
	2	0	1400 to 1599	PA255-16	EGA7-16
	2	1	1650 to 1799	PA255-18	EGA7-18
	2	1	1850 to 1999	PA255-20	EGA7-20
	2	1	2000 to 2100	PA255-21	EGA7-21
	2	2	2150 to 2400	PA255-24	EGA7-24

With bowl(s) L 600 x W 500 x H 300 mm

Customized		HEIGHT 900 mm	SINK	OPTIONAL SHELF supplied with sink	
WIDTH 700					
Designation	Nb of sink	Nb of drainer	Dimension top of catering sink mm	Ref.	Ref.
	1	0	850 to 999	PA165-10	EGA7-10
	1	0	1000 to 1199	PA165-12	EGA7-12
	1	1	1200 to 1399	PA165-14	EGA7-14
	2	0	1550 to 1599	PA265-16	EGA7-16
	2	0	1600 to 1899	PA265-19	EGA7-19
	2	1	1950 to 2100	PA265-21	EGA7-21
	2	2	2150 to 2399	PA265-24	EGA7-24
	2	2	2450 to 2600	PA265-26	EGA7-26



Standard suspended and semi-suspended catering sinks

Suspended version (same as sinks on feet):

- Work top : in AISI 304L 1.5 mm thickness stainless steel
- Frame in bent round stainless steel tube Ø 38 mm
- Frame fixed to the wall by screwing through the wall plates
- Top attaches to the wall by screwing of the rear profile
- Tap hole Ø 31 mm (optional cover)

Semi-suspended version:

- Frame in bent round stainless steel tube Ø 38 mm with welded legs
- Frame fixed to the wall by screwing through the wall plates
- Top attaches to the wall by screwing of the rear profile



Time saving of cleaning floor

With bowl(s) L 500 x W 500 x H 300 mm

Standard



		SUSPENDED VERSION		SEMI-SUSPENDED VERSION	
Designation	L x W mm	Kg	Ref.	Kg	Ref.
1 bowl	700 x 700	21	PAS107	22	PASS107
1 bowl + right drainer	1200 x 700	36	PAS112D	37	PASS112D
1 bowl + left drainer	1200 x 700	36	PAS112G	37	PASS112G
2 bowls	1200 x 700	36	PAS212	37	PASS212
2 bowls + right drainer	1600 x 700	48	PAS216D	49	PASS216D
2 bowls + left drainer	1600 x 700	48	PAS216G	49	PASS216G
2 bowls + right drainer	1800 x 700	54	PAS218D	55	PASS218D
2 bowls + left drainer	1800 x 700	54	PAS218G	55	PASS218G
2 bowls + 2 drainers	2100 x 700	53	PAS221	54	PASS221

Avec bac(s) de L 600 x L 500 x P 300 mm

		SUSPENDED VERSION		SEMI-SUSPENDED VERSION	
Designation	L x W mm	Kg	Ref.	Kg	Ref.
1 bowl	800 x 700	24	PAS108	25	PASS108
1 bowl + right drainer	1400 x 700	39	PAS114D	40	PASS114D
1 bowl + left drainer	1400 x 700	39	PAS114G	40	PASS114G
2 bowls	1400 x 700	39	PAS214	40	PASS214
1 bowl + right drainer	1500 x 700	45	PAS115D	46	PASS115D
1 bowl + left drainer	1500 x 700	45	PAS115G	46	PASS115G
2 bowls	1500 x 700	45	PAS215	46	PASS215
2 bowls + right drainer	1900 x 700	57	PAS219D	58	PASS219D
2 bowls + left drainer	1900 x 700	57	PAS219G	58	PASS219G
2 bowls + 2 drainers (3 tubes)	2400 x 700	65	PAS224	68	PASS224

Shipping within 48h

► **CUSTOMIZED** / Select a custom top module page 71 and add the TOP16 and TOP17 options page 80

OPTIONS
pages 80-81



ACCESSORIES
page 82





Sink units

- Drainer: grooved with non-drip edges
- Half-sized back to insert pipework
- 2 hanging sliding doors
- Lock
- Supplied with plug, simple overflow pipe and PVC U bend
- Tap hole Ø 31 (optional cover p. 82)
- No inner shelf
- On ABS feet



- 1 Work top in 15/10th (1.5 mm) thick with anti drip edge
- 2 10 mm curve
- 3 Welded corners with 20 mm radius front rounded edge and 60 mm thick work top
- 4 Backsplash with 30° slope edge (100 x 20 mm)
- 5 All stainless steel
- 6 155 mm ABS feet with adjustable height on 70 mm

+

Ergonomics: Cut angles to strengthen the body of the sink furniture

Safety: crushed folds

OPTIONS
pages 80-81

ACCESSORIES
page 82



MPA112G



MPA214



MPA216G



MPA224 (4 sliding doors and 2 cases)

With bowl(s) L 500 x W 500 x H 300 mm

WIDTH 700

Designation	HEIGHT 900 mm	SINGLE PANEL DOORS AND SIDES		DOUBLE PANEL DOORS AND SIDES	
		L x W mm	Kg	Ref.	Ref.
1 bowl + right drainer	1200 x 700	45	MPA112D	MPA3112D	
1 bowl + left drainer	1200 x 700	45	MPA112G	MPA3112G	
2 bowls	1200 x 700	45	MPA212	MPA3212	
2 bowls + right drainer	1600 x 700	61	MPA216D	MPA3216D	
2 bowls + left drainer	1600 x 700	61	MPA216G	MPA3216G	
2 bowls + right drainer	1800 x 700	68	MPA218D	MPA3218D	
2 bowls + left drainer	1800 x 700	68	MPA218G	MPA3218G	
2 bowls + 2 drainers	2100 x 700	90	MPA221	MPA3221	

With bowl(s) L 600 x W 500 x H 300 mm

WIDTH 700

Designation	HEIGHT 900 mm	SINGLE PANEL DOORS AND SIDES		DOUBLE PANEL DOORS AND SIDES	
		L x W mm	Kg	Ref.	Ref.
1 bowl + right drainer	1400 x 700	53	MPA114D	MPA3114D	
1 bowl + left drainer	1400 x 700	53	MPA114G	MPA3114G	
2 bowls	1400 x 700	53	MPA214	MPA3214	
1 bowl + right drainer	1500 x 700	57	MPA115D	MPA3115D	
1 bowl + left drainer	1500 x 700	57	MPA115G	MPA3115G	
2 bowls	1500 x 700	57	MPA215	MPA3215	
2 bowls + right drainer	1900 x 700	84	MPA219D	MPA3219D	
2 bowls + left drainer	1900 x 700	84	MPA219G	MPA3219G	
2 bowls + 2 drainers*	2400 x 700	107	MPA224	MPA3224	

Shipping within 48h

* Unit with 4 sliding doors and 2 cases

► CUSTOMIZED : CONSULT US



Special dishwasher sink







PA1MLD + EGA712ML

- For dishwashers (W 600 x D 600 x H 840 mm)
- Top in AISI 304L stainless steel with non-drip edges, 20 mm radius front rounded edge, 60 mm thick work top
- Backsplash with 30° slope edge 100 X 20 mm (rear closure optional)
- Tubular stainless steel feet Ø 38 mm, can be dismantled
- ABS feet adjustable up to 30 mm
- Draining board : grooved
- Supplied with plug, simple overflow pipe and PVC U bend
- Tap hole Ø 31 mm (optional cover p. 82)
- Empty space under drainer
- Optional shelf: only under sink

Sink without front and side panels - Bowl(S) L 500 x W 500 x H 300 mm

WIDTH 700

Designation	HEIGHT 900 mm L x W mm	SINK WITHOUT FRONT AND SIDE PANELS		OPTIONAL SHELF supplied with sink	
		Kg	Ref.	Kg	Ref.
 1 bowl + right drainer	1200 x 700	36	PA1MLD	8	EGA712ML
 1 bowl + left drainer	1200 x 700	36	PA1MLG	8	EGA712ML
 2 bowls + right drainer	1800 x 700	54	PA2MLD	12.5	EGA718ML
 2 bowls + left drainer	1800 x 700	54	PA2MLG	12.5	EGA718ML

Sink with front and side panels - Bowl(s) L 500 x W 500 x H 300 mm

WIDTH 700

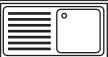
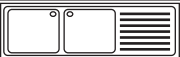
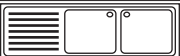
Designation	HEIGHT 900 mm L x W mm	SINK WITH FRONT AND SIDE PANELS		OPTIONAL SHELF supplied with sink	
		Kg	Ref.	Kg	Ref.
 1 bowl + right drainer	1200 x 700	36	PAP1MLD	8	EGA712ML
 1 bowl + left drainer	1200 x 700	36	PAP1MLG	8	EGA712ML
 2 bowls + right drainer	1800 x 700	54	PAP2MLD	12.5	EGA718ML
 2 bowls + left drainer	1800 x 700	54	PAP2MLG	12.5	EGA718ML

 Shipping within 48h

OPTIONS
pages 80-81



ACCESSORIES
page 82





Standard pot sinks



PQ7115D + EGQ715

- Top : AISI304 L stainless steel - Thickness 15/10th (1.5 mm) with anti drip edges
- Front edge : 20 mm radius, 60 mm thick work top
- Backsplash 100 x 20 mm, 30° slope edge, closed sides (optional rear cover). 10 mm radius at the base
- Drainage : ribbed
- Faucet hole : 31 mm (optional cover page 82)
- Base : welded stainless steel frame in square tubes 35 x 35 mm , with ABS feet adjustable on 30 mm (6 feet for 2400 mm length)
- Delivered with plug, overflow tube and PVC U Bend



BIG BOWLS = IDEAL FOR BIG POTS

Width 700 mm - With bowl(s) L 800 x W 500 x H 375 mm

Standard		HEIGHT 900 mm	POT SINK	OPTIONAL FULL SHELF WITH STRAIGHT EDGES		
WIDTH 700						
Designation	Nb of feet	L x W mm	Kg	Ref.	Kg	Ref.
1 bowl	4	1000 x 700	17	PQ7110	7.6	EGQ710
1 bowl + right drainer	4	1500 x 700	25	PQ7115D	11	EGQ715
1 bowl + left drainer	4	1500 x 700	25	PQ7115G	11	EGQ715
2 bowls	4	1800 x 700	47	PQ7218	13.6	EGQ718
2 bowls + right drainer	6	2400 x 700	41	PQ7224D	18	EGQ724
2 bowls + left drainer	6	2400 x 700	41	PQ7224G	18	EGQ724

Width 800 mm - With bowl(s) L 800 x W 600 x H 450 mm

Standard		HEIGHT 900 mm	POT SINK	OPTIONAL FULL SHELF WITH STRAIGHT EDGES		
WIDTH 800						
Designation	Nb of feet	L x W mm	Kg	Ref.	Kg	Ref.
1 bowl + right drainer	4	1500 x 800	28	PQ8115D	13	EGQ815
1 bowl + left drainer	4	1500 x 800	28	PQ8115G	13	EGQ815
2 bowls + right drainer	6	2400 x 800	46	PQ8224D	20	EGQ824
2 bowls + left drainer	6	2400 x 800	46	PQ8224G	20	EGQ824

► **CUSTOMIZED** / See our customized pot sinks
page 76

OPTIONS
pages 80-81



ACCESSORIES
page 82



Customized pot sinks

- Top 1.5 mm thickness, with non-drip edges
- 20 mm radius front rounded edge, 60 mm thick work top
- Backsplash with 30° slope edge, 100 x 20 mm – radius 10 mm at the bottom of the backsplash
- Ribbed drainer (smooth drainer in option page 80)
- 1 tap hole Ø 31 mm. Possible without hole or with 2 holes : see options page 80.
- Frame and feet : welded frame in 35 x 35 mm square tubular stainless steel with front and side panels
- Supplied with plug, simple overflow pipe and PVC U bend
- 4 ABS feet, 6 feet from length 2200 mm



Width 700 mm - With bowl(s) L 800 x W 500 x H 375 mm

Customized			HEIGHT 900 mm	POT SINK	OPTIONAL SHELF supplied with sink
WIDTH 700					
Designation	Nb of sink	Nb of drainer	Dimension top of catering sink mm	Ref.	Ref.
	1	0	1050 to 1399	PQ185-14	EGQ7-14
	1	1	1400 to 1499	PQ185-15	EGQ7-15
	1	1	1550 to 1800	PQ185-18	EGQ7-18
	2	0	1850 to 2099	PQ285-21	EGQ7-21
	2	0	2100 to 2399	PQ285-24	EGQ7-24
	2	1	2450 to 2600	PQ285-26	EGQ7-26

Width 800 mm - With bowl(s) L 800 x W 600 x H 450 mm

Customized			HEIGHT 900 mm	POT SINK	OPTIONAL SHELF supplied with sink
WIDTH 800					
Designation	Nb of sink	Nb of drainer	Dimension top of catering sink mm	Ref.	Ref.
	1	0	1050 to 1499	PQ186-15	EGQ8-15
	1	1	1550 to 1799	PQ186-18	EGQ8-18
	2	0	1800 to 1999	PQ286-20	EGQ8-20
	2	0	2000 to 2100	PQ286-21	EGQ8-21
	2	1	2450 to 2600	PQ286-26	EGQ8-26

OPTIONS
pages 80-81



ACCESSORIES
page 82





Options for straight edges and rounded edge catering sinks

Racks bottom shelf

- All stainless steel
- 35 x 35 mm square tube

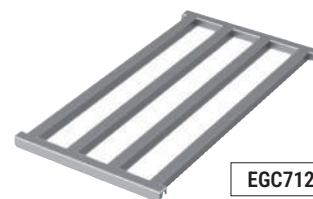

	WIDTH 600 mm		WIDTH 700 mm	
	FOR STRAIGHT EDGES CATERING SINKS		FOR STRAIGHT EDGES AND ROUNDED EDGE CATERING SINKS	
For catering sink length mm	Kg	Ref.	Kg	Ref.
1000	5.2	EGC610	7	EGC710
1200	6	EGC612	8.2	EGC712
1400	6.5	EGC614	9.4	EGC714
1500	7	EGC615	10	EGC715
1600	7.4	EGC616	10.7	EGC716
1800	8	EGC618	12	EGC718
2000	9	EGC620	13.2	EGC720
2200	9.5	EGC622	14.5	EGC722

Other options

Std : standard,
CM : customized

		FOR CATERING SINKS WITH			
		STRAIGHT EDGES	ROUNDED EDGE		Ref.
Designation		Std	Std	CM	
Legs / feet & castors					
4 stainless steel feet - Add X to the end of the reference		✓	✓	✓	.../X
4 stainless steel castors Ø 125 mm (2 with brake) - Add RX to the end of the reference		✓	✓	✓	.../RX
4 stainless steel feet for sink unit - Add X to the end of the reference		Sink unit	Sink unit	Sink unit	.../X
4 stainless steel castors for sink unit width 700 mm only, Ø 125 mm (2 with brake) - Add RX to the end of the reference		Sink unit	Sink unit	Sink unit	.../RX
4 polyamid castors Ø 125 mm (2 with brake) - Add RP to the end of the reference		✓	✓	✓	.../RP
Semi-mobile option	2 castors polyamid cover without brake and 2 stainless adjustable legs in front - Add SMP to the end of the ref.	✓	✓	✓	.../SMP
	2 castors stainless cover without brake and 2 stainless adjustable legs in front - Add SMX to the end of the ref.	✓	✓	✓	.../SMX
Special height legs For tray height 1050 mm maximum (otherwise consult us). Specify the desired height of the material when ordering		✓	✓		SPHT
2 hanging consoles (extra cost to add to the price of customized catering sinks on 4 ABS adjustable legs) Price is x1,5 for length upper than 2200 mm (3 consoles)				✓	TOP16
2 semi-hanging consoles (extra cost to add to the price of customized catering sinks on 4 ABS adjustable legs) Price is x1,5 for length upper than 2200 mm (3 consoles)				✓	TOP17



Options for straight edges and rounded edge catering sinks

Std : standard,
CM : customized

FOR CATERING SINKS WITH

Designation	STRAIGHT EDGES		ROUNDED EDGE		Ref.
	Std		Std	CM	
Structure & reinforcement					
Lateral and longitudinal bottom crosspieces (U or H shape: please notify on the order). <i>Non available on suspended or semi-suspended sinks</i>			✓	✓	TRAV
4 feet welded on the side strips <i>For tables with 6 feet, prices x 1,5</i>			✓	✓	SPSOUD
Panels					
Stainless steel panels (3 faces) for standard suspended and semi-suspended sinks			✓		TOP15
Stainless steel panels (3 faces)				✓	POPT04
Knee operated: for sinks with sink cover from length 1200 mm - Delivered with front panel with pre-mixer, swan neck and push tap	✓		✓	✓	CEAUV
Backsplashes					
Rear backsplash closure		✓	✓	✓	TFD
Side raised backsplash: Welded and siliconed, rear not closed	For sinks width 600 mm	On the right	✓		TTDR610D
		On the left	✓		TTDR610G
	For sinks width 700 mm	On the right	✓		TTDR710D
		On the left	✓		TTDR710G
Side raised backsplash: Welded and siliconed, rear not closed	For sinks width 700 mm	On the right		✓	TTDR710AD
		On the left		✓	TTDR710AG
Rear backsplash height 300 mm (per lm)				✓	POPT14
Manufactured side backsplash 100x20 mm integrated to the top Possibility of adding 2 side sheet metal backsplashes up to 2700 mm. <i>Warning, only 1 side sheet metal backsplash from 2701 to 2800 mm max.</i>				✓	CONSULT US
finishing & worktop					
Vibrated polishing (in circles) (per lm)				✓	TOP10
Smooth drainer				✓	POPT17
Drainer with 2 mm thickness instead of 1.5 mm (per lm)				✓	CONSULT US
Dry zone for waste discharge hole (without TVO - option TTVDC to add with TVO)				✓	CONSULT US
Interior fittings for sink unit - bottom shelf + partition			Sink unit		POPT16



TOP16



TOP17



CEAUV



TTRD710AD

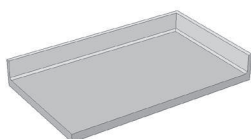

Side raised backsplash



TOP10

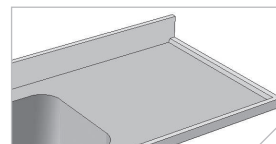

POPT17

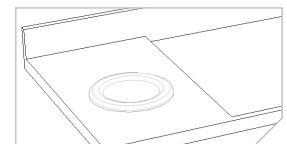

Dry zone for TVD



Accessories for standard and customized catering sinks

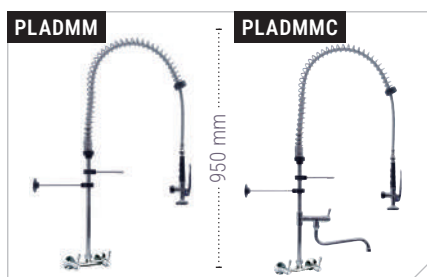
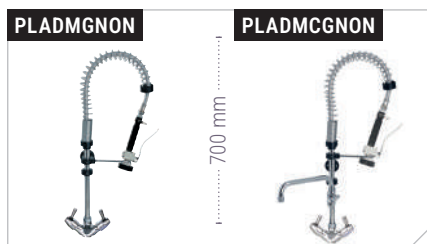
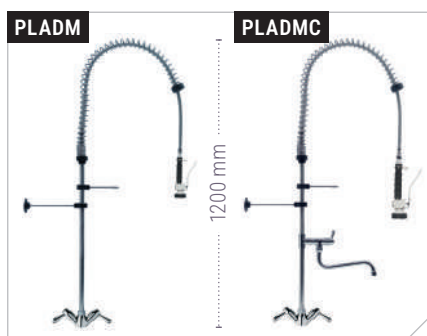

Designation	Ref.
-------------	------

Faucet to fix on sink

Mixer spray-heads to fix on sink Height 1200 mm

Fixed to the table + wall fixing bracket - Stainless steel AISI 304L - Mixer with non-return valves according to European standard EN13959 - Safety spring - Flexible I. 1200 mm in AISI 304L stainless steel braid + EPDM standard, nd 12.5 - Flow rate in liters per minute for a pressure of 3/4 bars: 17 l/min - Total height: 1200 mm - Ergonomic grips with turn valve head - HW/CW taps with high-quality ceramic head - Spray head in stainless steel interior according to European standards CE, ROHS and ACS

Without drawing tap	PLADM
With drawing tap with swivel telescopic spout	PLADMC

Mixer spray-heads « Mignon » model Height 700 mm

Ideal to go under the wall cabinets

Without drawing tap	PLADMGNON
With drawing tap with swivel telescopic spout	PLADMCGNON

1/4 turn tap: Single hole with swan's neck	PLARQT1
--	----------------

Mixer tap: Single hole	PLAROBIML
------------------------	------------------

Wall faucet

Wall mixer spray-heads

Idem PLADMC except : wall fixation, height 950 mm

Without drawing tap	PLADMM
With drawing tap with swivel telescopic spout	PLADMMC

Wall mixer taps

Twin-hole - 1/4 turn - Wall fixation - Spout length 250 mm

Swivel spout from below	PLARMQT2
Swivel spout from above	PLARMQT3

Chromed cover: For the tap hole	CT50
---------------------------------	-------------

U bends

PVC	PLASIPHPL
Chromed brass	PLASIPHLA

Plug	PVC	Brass*
Perforated overflow pipe: Makes catching waste easier and prevents the risk of the U bend getting blocked	H180 mm	POPTUB18
	H230 mm	POPTUB23
	H280 mm	POPTUB28
	H350 mm	POPTUB35
	H430 mm	POPTUB43

Perforated plate for tank bottom heights:

Compatible only with Sofinor catering sinks - With tube hole for overflow - Specify when ordering the position of the drain - If separate order of the plunge, provide the tank rays

For sink 500x400, 500x500 and 600x 500 - Height 100 mm	POGDH
For sink 800x500 and 800x600 - Height 150 mm	POGDHQ

Straight sink exhaust pipe without tap**:

Tubular 42,4 mm without valve - Non available on sink with integral bottom shelf

Simple	PLAVISV*
Double Y	PLAVIDSV*

Straight sink exhaust pipe with tap (s)**:

With 1/4 40 x 49 female turn(s) and AISI 304L stainless steel outlet pipe(s) (distance from floor about 80 mm depending on) Non available on sink with integral bottom shelf

Simple	PLAVI*
Double Y	PLAVID*

Shipping within 48h

*Brass plug required when ordering PLAVI, PLAVID, PLAVISV, PLAVIDSV
**For the price of offset or angled drains, please consult us